

**100° Flat Head**

Screw Size Tension Head	Screw Size Reduced Head	Cruciform Punch Number
2		3P10-80
3		3P10-1
4		3P10-54
6	8	3P20-1
8	10	3P20-135
10	1/4	3P20-136
1/4	5/16	3P30-93
5/16	3/8	3P40-79
3/8	7/16	3P40-106
7/16	1/2	3P40-24
1/2	9/16	3P40-2
9/16	5/8	3P40-3

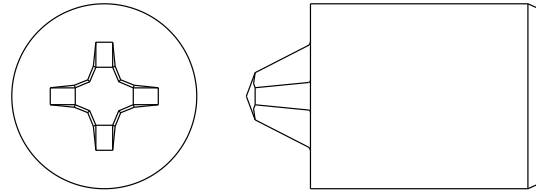

**100° Oval Head**

Screw Size	Cruciform Punch Number
2	3P10-82
3	3P10-83
4	3P10-84
6	3P20-8
8	3P20-12
10	3P20-13
1/4	3P30-12
3/16	3P40-13
3/8	3P40-10

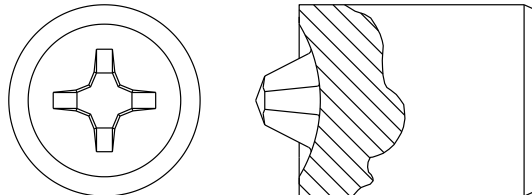

**Trimmed Hexagon Head**

Screw Size	Cruciform Punch Number
4	3P10-157
6	3P20-137
8	3P20-474
10	3P20-147
1/4	3P30-58
5/16	3P40-65
3/8	3P40-66
7/16	3P40-67
1/2	3P40-68

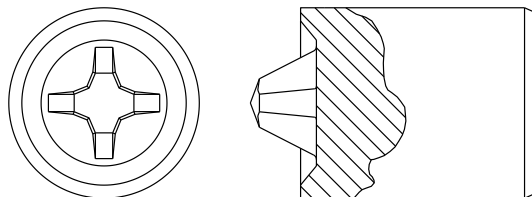

1. **Punch materials:**
  - M2 at RC 62-64
  - M42 at RC 63-65
2. **Punches available with headmarking and company logo. Please specify when ordering.**
3. **PVD Coatings available for cold & hot heading applications.**

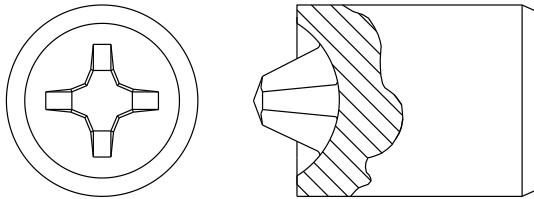

**Pan Head**

Screw Size	Cruciform Punch Number
2	3P10-13
3	3P10-14
4	3P10-15
6	3P20-21
8	3P20-23
10	3P20-25
1/4	3P30-22
5/16	3P40-9
3/8	3P40-26
7/16	3P40-27
1/2	3P40-28
9/16	3P40-141

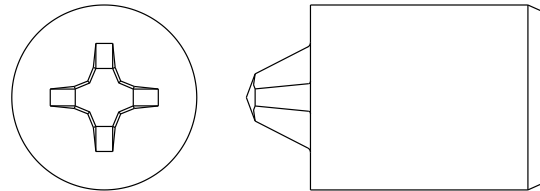

**Flat Fillister Head**

Screw Size	Cruciform Punch Number
2	3P10-13
3	3P10-14
4	3P10-15
6	3P20-21
8	3P20-23
10	3P20-25
1/4	3P30-22
5/16	3P40-9
3/8	3P40-26
7/16	3P40-27
1/2	3P40-28
9/16	3P40-281

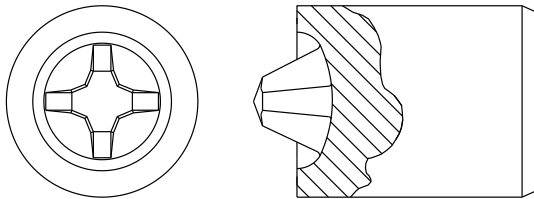

**Pan Head Double Radius**

Screw Size	Cruciform Punch Number
4	3P10-157
6	3P20-137
8	3P20-474
10	3P20-147
1/4	3P30-58
5/16	3P40-65
3/8	3P40-66
7/16	3P40-67
1/2	3P40-68

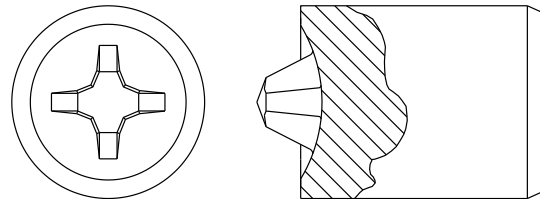

**Brazier Head**

Screw Size	Cruciform Punch Number
6	3P20-125
8	3P20-126
10	3P20-127
1/4	3P30-88
5/16	3P40-134
3/8	3P40-136
7/16	3P40-225
1/2	3P40-227
9/16	3P40-211

**1. Punch materials:**

- M2 at RC 62-64
- M42 at RC 63-65

**2. Punches available with headmarking and company logo. Please specify when ordering.**

**3. PVD Coatings available for cold & hot heading applications.**